

Serene Infra Red Switch



Installation and Operating Instructions



Model Numbers:

1502 - ____ 01 _ (1 button)
1502 - ____ 02 _ (2 button)
1502 - ____ 04 _ (4 button)

Specifications:

Power Supply:	2 x AAA alkaline batteries
Expected battery Life:	4 - 7 years
Infrared Coverage:	Non-directional - 5 metre radius Directional - 12 metres (IR switch is pointed at IR Receiver Unit).
Ambient Operating Temp:	0 - 55°C
Environmental Rating:	IP30

Features:

The TARA Infranet IR switch may be wall mounted or portable. Full room infrared coverage is provided - the infrared switch unit doesn't need to be pointed at the receiver unit.

Each pushbutton on the switch unit is individually programmable. Buttons may be assigned any system function (light, dimmer, ceiling fan, master scene control, etc.).

The switch features sleek styling and is supplied with a custom tool allowing the removal of the front cover during installation and to provide access to batteries when servicing.

SELV CE N14294

Serene Infra Red Switch



Installation and Operating Instructions

1 Remove Cover

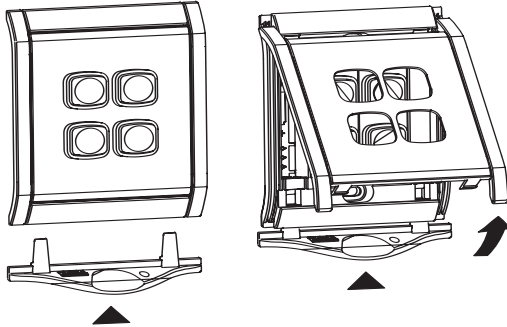

Insert tool into slots to remove cover.

2 Insert Batteries

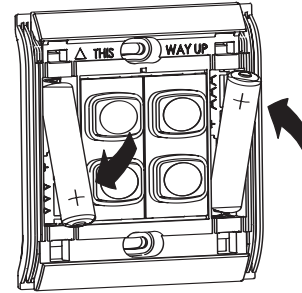

Insert batteries ensuring correct polarity.

3 Program

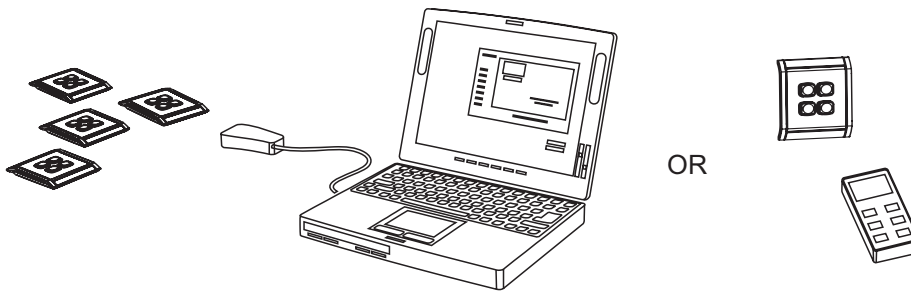

Program using TARA InfraMouse and InfraLink Software for Windows. See software helpfiles for instructions.

OR

Program using TARA TechAid. See instructions supplied with TechAid.

4 Install

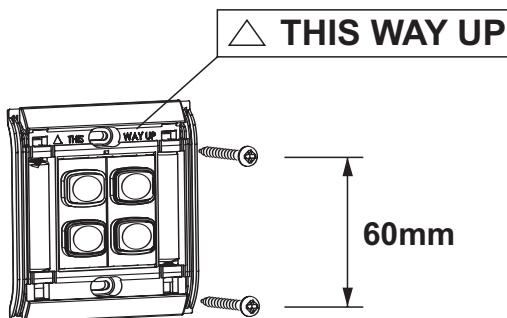

Install right way up.
Use screws provided if required.

5 Replace Cover

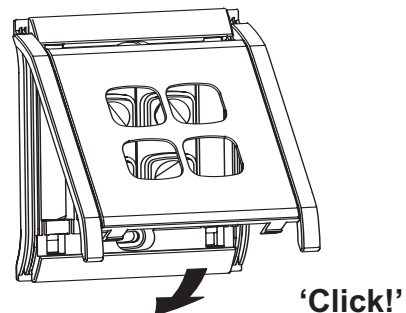

Replace Cover.

WARRANTY This product is guaranteed for 3 years from the date of purchase against electrical, and 1 year from the date of purchase against mechanical, defects in materials or workmanship used in or associated with the manufacture and assembly of the equipment. The guarantee applies only to the original owner and is not transferable.

The guarantee does not cover failure due to accidental damage, lightning strike, misuse, short circuited, loading beyond rating, negligence or any alteration whatsoever to the form or content of the equipment. The guarantee becomes null and void if any adjustment, part replacement or repair is carried out by any person other than an authorised service agent.

The purchaser shall be responsible for any expenses involved in making the equipment readily accessible for servicing, and where the equipment is installed outside the capital city metropolitan area of the retailer, for any travelling expenses and any costs for transporting the equipment or parts thereof to and from the retailer or service branch. The purchaser must produce proof of the date of purchase together with this guarantee when making a claim.

TARA Holding Pty. Ltd. reserves the right to change designs or specifications described in this manual without obligation and without notice.

